

WINTECH MOTORS

DC Motors

R540/545 SERIES

Typical Applications:

Power Tools

Household Appliances



WEIGHT: 156.0 g (APPROX)

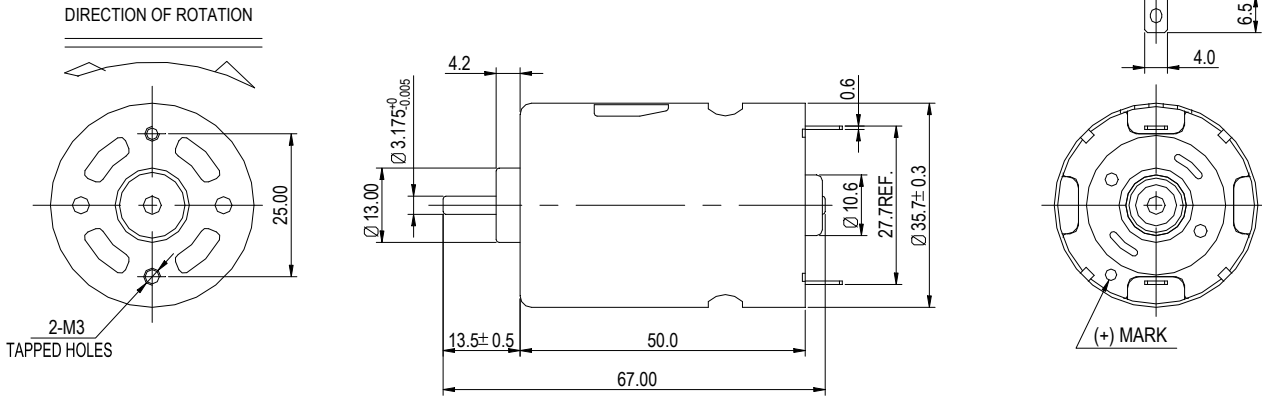

UNIT : mm

| MODEL | VOLTAGE | | NO LOAD | | AT MAX.EFFICIENCY | | | | | STALL | |
|-----------------|-----------------|---------|---------|---------|-------------------|---------|--------|--------|------|---------|--------|
| | OPERATING RANGE | NOMINAL | SPEED | CURRENT | SPEED | CURRENT | TORQUE | OUTPUT | EFF. | CURRENT | TORQUE |
| | | | rpm | A | rpm | A | g-cm | W | % | A | g-cm |
| RS540SM-6530-67 | 3.6~7.2V | 7.2V | 16000 | 1.2 | 14120 | 9.02 | 257.0 | 37.24 | 65.8 | 67.8 | 2190.0 |
| RS540SM-5045-67 | 4.5~12.0V | 12.0V | 17500 | 0.95 | 15000 | 5.94 | 325.0 | 50.30 | 70.7 | 37.00 | 2350.0 |
| RS545SP-2588-67 | 6.0~24.0V | 24.0V | 9400 | 0.19 | 7870 | 0.97 | 222.0 | 17.90 | 76.5 | 5.00 | 1360.0 |
| RS545SM-4522-67 | 3.6~12V | 10.0V | 23300 | 1.20 | 19100 | 5.60 | 180.0 | 36.00 | 59.2 | 26.00 | 1020.0 |

RS540SM-6530-67 7.2 V

RS545SP-2588-67 24.0 V

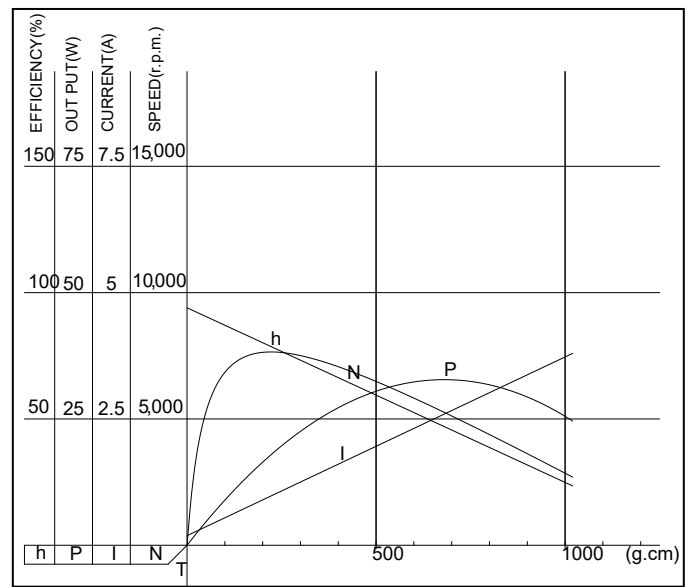
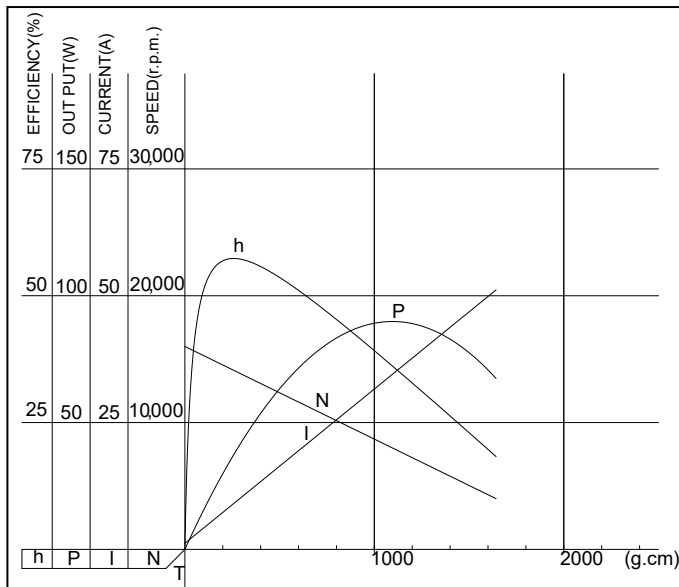

Wintech Precision Industrial Ltd.

Http://www.wintechpil.com